

PWC KIT - Foot Rest Kit

Product:	Sea-Doo_watercraft
Project no:	487802199_rev1
Instruction Sheet P/N:	487802199
Revision no:	1
Revision date:	October 2022
Item covered:	Foot Rest Kit

The following symbols may be used in this document:



WARNING

Indicates a hazardous situation which, if not avoided, could result in death or serious injury.



CAUTION: Indicates a hazard situation which, if not avoided, could result in minor or moderate injury.

NOTICE Indicates an instruction which, if not followed, could severely damage vehicle components or other property.



WARNING

- For safety reasons, this kit must be installed by an authorized BRP dealer.
- This kit is designed for specific applicable models only (authorized BRP dealers will confirm model(s)). It is not recommended for units other than the one (those) for which it was sold.



WARNING

Some important safety information and/or operating instructions dedicated to the end user might be included in this instruction sheet. Make sure to give the kit part number as well as the instruction sheet included with this kit to the customer. Verify that the customer has access to all the information required for proper use of the accessory.

NOTE: USE TIGHTENING TORQUES IN THE FOLLOWING TABLE IF NOT OTHERWISE SPECIFIED.

GRADE

	5.8	8.8	10.9	12.9
M4	1.8 ± 0.2 N•m (16 ± 2 lbf•in)	2.8 ± 0.2 N•m (25 ± 2 lbf•in)	3.8 ± 0.2 N•m (34 ± 2 lbf•in)	4.5 ± 0.5 N•m (40 ± 4 lbf•in)
M5	3.3 ± 0.2 N•m (29 ± 2 lbf•in)	5 ± 0.5 N•m (44 ± 4 lbf•in)	7.8 ± 0.7 N•m (69 ± 6 lbf•in)	9 ± 1 N•m (80 ± 9 lbf•in)
M6	7.5 ± 1 N•m (66 ± 9 lbf•in)	10 ± 2 N•m (89 ± 18 lbf•in)	12.8 ± 2.2 N•m (113 ± 19 lbf•in)	16 ± 2 N•m (142 ± 18 lbf•in)
M8	15.3 ± 1.7 N•m (135 ± 15 lbf•in)	24.5 ± 3.5 N•m (18 ± 3 lbf•ft)	31.5 ± 3.5 N•m (23 ± 3 lbf•ft)	40 ± 5 N•m (30 ± 4 lbf•ft)
M10	29 ± 3 N•m (21 ± 2 lbf•ft)	48 ± 6 N•m (35 ± 4 lbf•ft)	61 ± 9 N•m (45 ± 7 lbf•ft)	73 ± 7 N•m (54 ± 5 lbf•ft)
M12	52 ± 6 N•m (38 ± 4 lbf•ft)	85 ± 10 N•m (63 ± 7 lbf•ft)	105 ± 15 N•m (77 ± 11 lbf•ft)	128 ± 17 N•m (94 ± 13 lbf•ft)
M14	85 ± 10 N•m (63 ± 7 lbf•ft)	135 ± 15 N•m (100 ± 11 lbf•ft)	170 ± 20 N•m (125 ± 15 lbf•ft)	200 ± 25 N•m (148 ± 18 lbf•ft)

M16	126 ± 14 N•m (93 ± 10 lbf•ft)	205 ± 25 N•m (151 ± 18 lbf•ft)	255 ± 30 N•m (188 ± 22 lbf•ft)	305 ± 35 N•m (225 ± 26 lbf•ft)
M18	170 ± 20 N•m (125 ± 15 lbf•ft)	273 ± 32 N•m (201 ± 24 lbf•ft)	330 ± 25 N•m (243 ± 18 lbf•ft)	413 ± 47 N•m (305 ± 35 lbf•ft)

NOTE: The illustrations in this document show typical construction of the different assemblies and may not reproduce the full detail or exact shape of the parts; however, they represent parts that have the same or similar function.

Installation time is approximately **1.25** hour.

Items in Kit

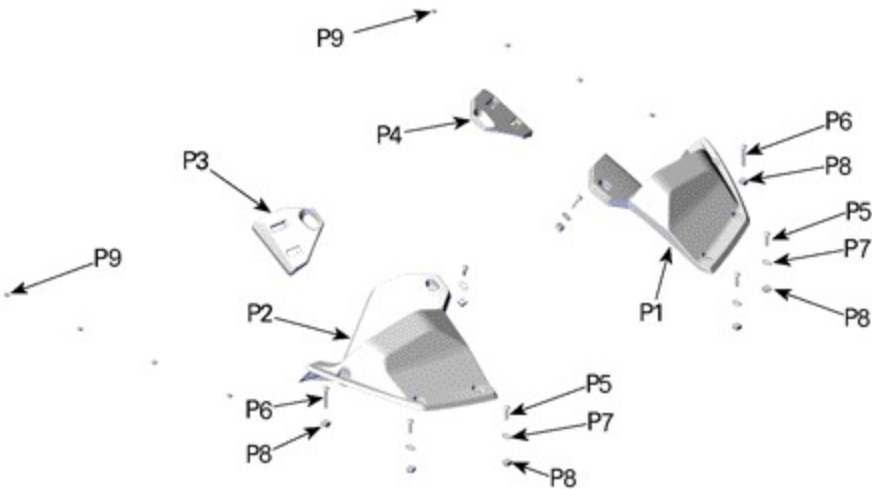

ITEM	DESCRIPTION	PART NUMBER	QTY
P1	RH Foot Rest Assembly	291004539	1
P2	LH Foot Rest Assembly	291004540	1
P3	LH Rear Support	291004545	1
P4	RH Rear Support	291004546	1
P5	M6 X 30 Plastite Screw	250001138	6
P6	M6 X 45 Plastite Screw	250001144	2
P7	Oval Washer	291003880	8
P8	M6 Plastite Housing Nut	291003793	8
P9	M6 Hexagonal Elastic Nut	232561200	10

Instructions

Installation

All Models

Remove and discard the four (4) screws and the two (2) oval washers shown in image below.



- 1. M6 X 30 Torx Flanged Screw
- 2. Oval Washer

Remove and discard covers.

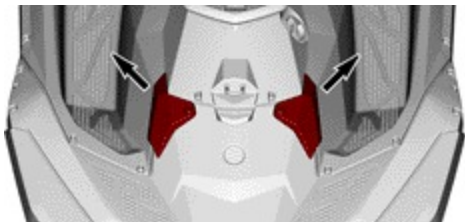

Install LH rear support [P3] and RH rear support [P4] on vehicle.



1. LH rear support [P3] and RH rear support [P4]
Install LH foot rest [P2] and mark lower holes.

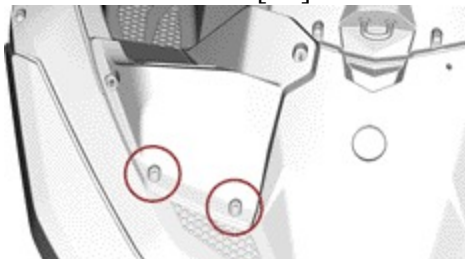

Remove LH foot rest [P2] and LH rear support [P3].
Repeat steps for RH side.

Remove rear body. Refer to appropriate subsections in your *SERVICE MANUAL*.

CAUTION: Rear body must absolutely be removed prior to drilling marked holes. Doing otherwise could damage mechanical components underneath.

Drill 12 mm (15/32 in) holes on the four (4) marks previously made.
For Spark 2016 and older

NOTE: These models, must be equipped with the two (2) parts indicated in the table below.

DESCRIPTION	PART NUMBER	QTY
M6 Expansion Nut	250100150	4
M6 X 30 Torx Flanged Screw	250000604	6

Remove and discard the four (4) housing nuts shown in the image below. Replace them with four (4) M6 Plastite housing nut [P8].

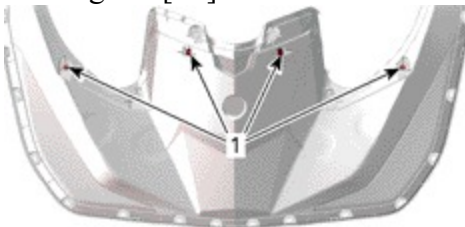

1. M6 Plastite housing nut [P8]
Install rear body. Refer to appropriate subsections in your *SERVICE MANUAL*.
Install LH rear support [P3] and RH rear support [P4] on vehicle.



1. LH rear support [P3] and RH rear support [P4]

Install M6 expansion nut in previously drilled 12 mm holes.

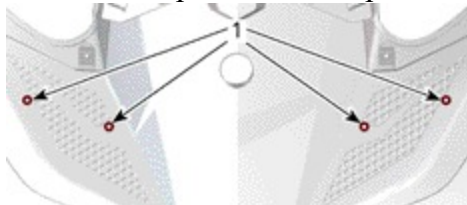

1. M6 expansion nut

Install LH foot rest with LH rear support. Secure with three (3) M6 X 30 Torx flanged screw, one (1) M6 X 45 Plastite screw [P6] and four (4) oval washer [P7].

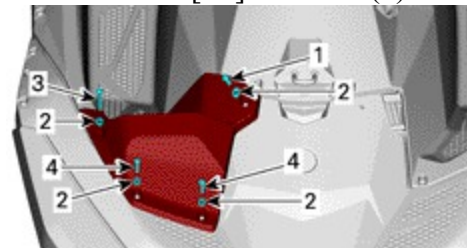

1. M6 X 30 Torx flanged screw

2. Oval washer [P7]

3. M6 X 45 Plastite screw [P6]

4. M6 X 30 Torx flanged screw

Apply torques according to item numbers in image above.

Tightening Torque

1	M6 X 30 Torx Flanged Screw	$5.5 \pm .5 \text{ N}\cdot\text{m}$ ($49 \pm 4 \text{ lbf}\cdot\text{in}$)
3	M6 X 45 Plastite Screw [P6]	$3.5 \pm 0.5 \text{ N}\cdot\text{m}$ ($31 \pm 4 \text{ lbf}\cdot\text{in}$)
4	M6 X 30 Torx Flanged Screw	$1.5 \pm .5 \text{ N}\cdot\text{m}$ ($13 \pm 4 \text{ lbf}\cdot\text{in}$)

Repeat steps for RH side.

For Spark 2017 and up

Remove and discard the four (4) housing nuts shown in the image below. Replace them with four (4) M6 Plastite housing nut [P8].

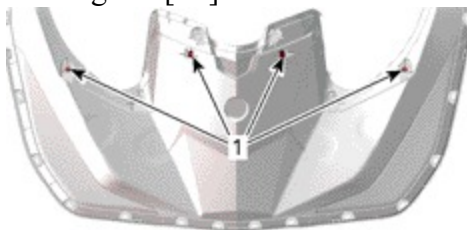

1. M6 Plastite housing nut [P8]

Install four (4) M6 Plastite housing nut [P8].

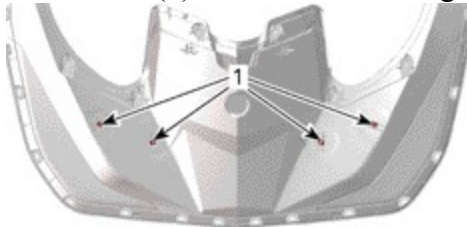

1. M6 Plastite housing nut [P8]

Install rear body. Refer to appropriate subsections in your *SERVICE MANUAL*.

Install LH rear support [P3] and RH rear support [P4] on vehicle.



1. LH rear support [P3] and RH rear support [P4]

Install LH foot rest with LH rear support. Secure with three (3) M6 X 30 Plastite screws [P5], one (1) M6 X 45 Plastite screw [P6] and four (4) oval washer [P7].

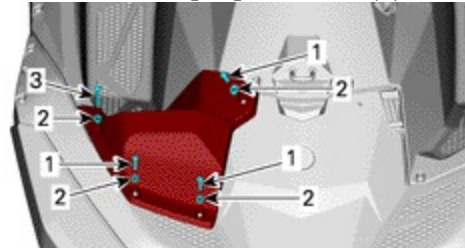

- 1. M6 X 30 Plastite screws [P5]
- 2. Oval washer [P7]
- 3. M6 X 45 Plastite screw [P6]

Tightening Torque

M6 X 30 Plastite screws [P5]	3.5 ± 0.5 N•m (31 ± 4 lbf•in)
M6 X 45 Plastite screw [P6]	3.5 ± 0.5 N•m (31 ± 4 lbf•in)

Repeat steps for RH side.